

CATAWBA DISTRIBUTION CENTER

FOR LEASE



1962 WEST HWY 160, FORT MILL, SC

- 100,000 SF Available
- 7,500 SF of Office Space
- 9 Existing Dock Doors (expandable)
- 1 drive-in door
- Trailer Spaces Available
- 30' Clear Height
- 50' x 50' Typical Bay Size
- ESFR Sprinkler System
- 200' Building Depth
- Ample Parking
- ±1 mile from I-77

CLARUS
PROPERTIES, INC

The information contained herein has either been given to us by the owner of the property or has been obtained from sources that we deem reliable. We have no reason to doubt its accuracy, but we do not guarantee it. This property is subject to prior sale, lease, price change or withdrawal without notice. Note: Broker participation is welcomed. Compensation is offered to buyer/tenant.

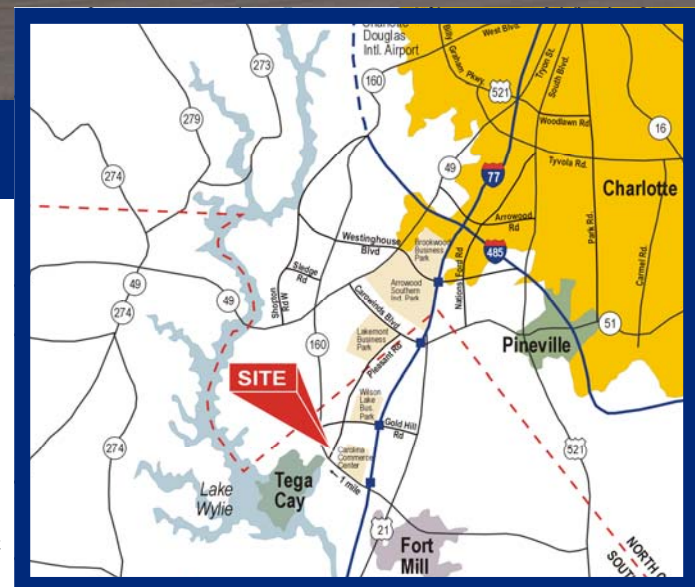

CATAWBA DISTRIBUTION CENTER

York County, South Carolina

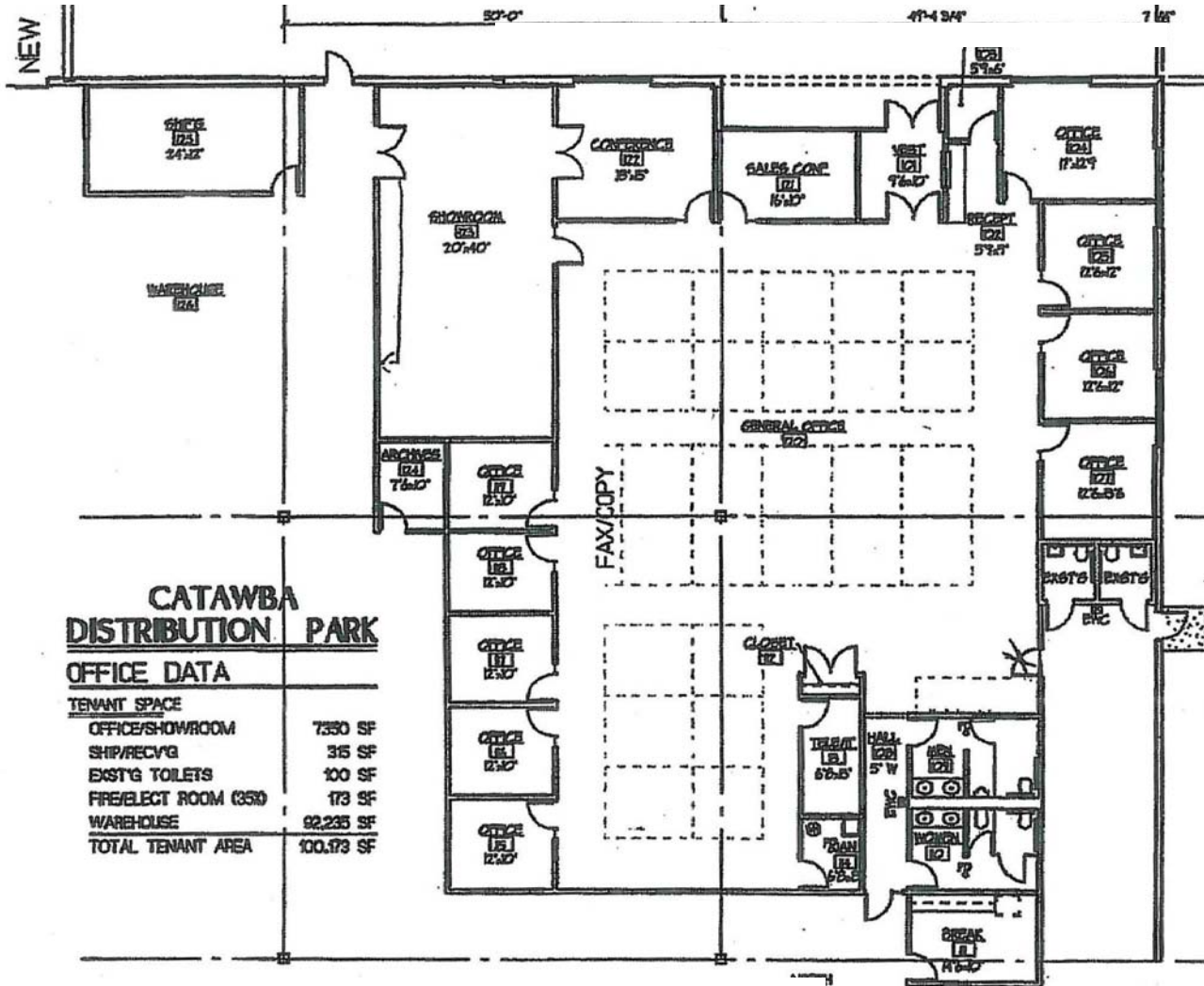

CATAWBA DISTRIBUTION PARK

OFFICE DATA

TENANT SPACE	
OFFICE/SHOWROOM	7350 SF
SHIP/RECV'G	316 SF
EXIST'G TOILETS	100 SF
FIRE/ELECT ROOM (850)	173 SF
WAREHOUSE	92,235 SF
TOTAL TENANT AREA	100,173 SF

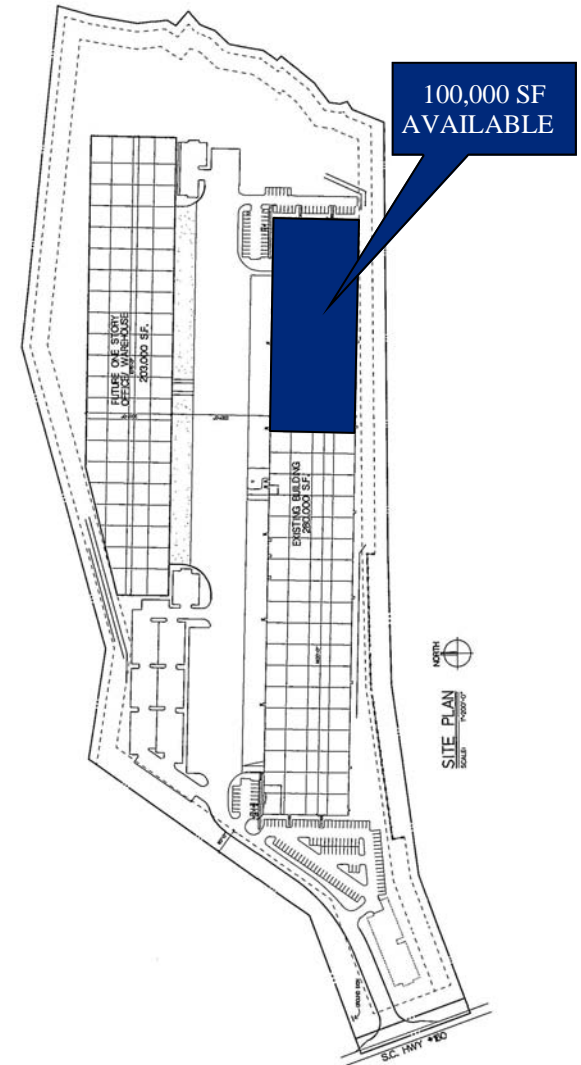

FOR LEASING INFORMATION CONTACT:

LAWRENCE SHAW, SIOR
lshaw@clarusproperties.com
704.409.2360

GRANT MILLER
gmiller@clarusproperties.com
704.409.2364

www.clarusproperties.com

CLARUS
 PROPERTIES, INC