

FOR SUBLEASE > FLEX SPACE



University Research Park

9711 DAVID TAYLOR DRIVE, CHARLOTTE, NC



University Research Park > Flex Space

This stand alone production facility features private offices, an air conditioned production area and is located directly off I-85 within The University Research Park.

Located in Charlotte's northeast submarket, University Research Park is a 2,200 acre office/light industrial park loaded with amenities including restaurants, shopping, hotels and walking trails.

Building Amenities

- > 38,120 SF total
- > 19,686 SF office (2 story)
- > 13,832 SF production space (A/C)
- > 4,602 SF of warehouse
- > 21' clear height in warehouse
- > 3 dock doors
- > 800 AMP 480/277 volt
- > 130 auto parking spaces
- > Immediate access to I-85
- > \$5.25 PSF NNN
- > Lease term expires 8/2011

GREG COPPS SIOR
704 409 2361
CHARLOTTE, NC
greg.copps@colliers.com

COLLIERS INTERNATIONAL
212 S. Tryon Street, Suite 375
Charlotte, NC 28281
www.colliers.com

University Research Park > Floor Plan

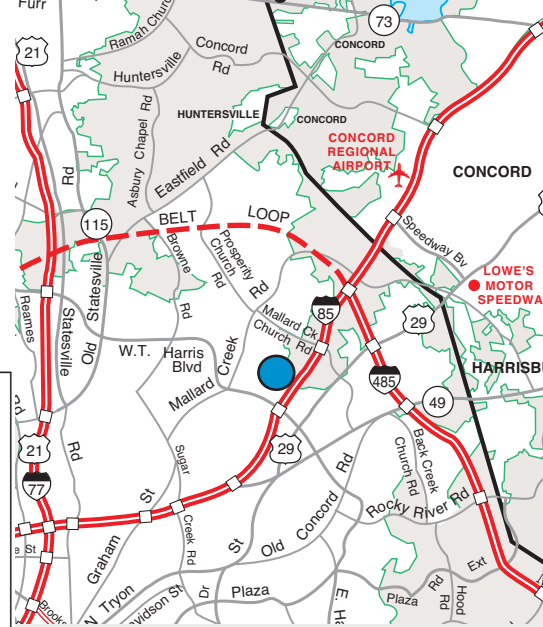
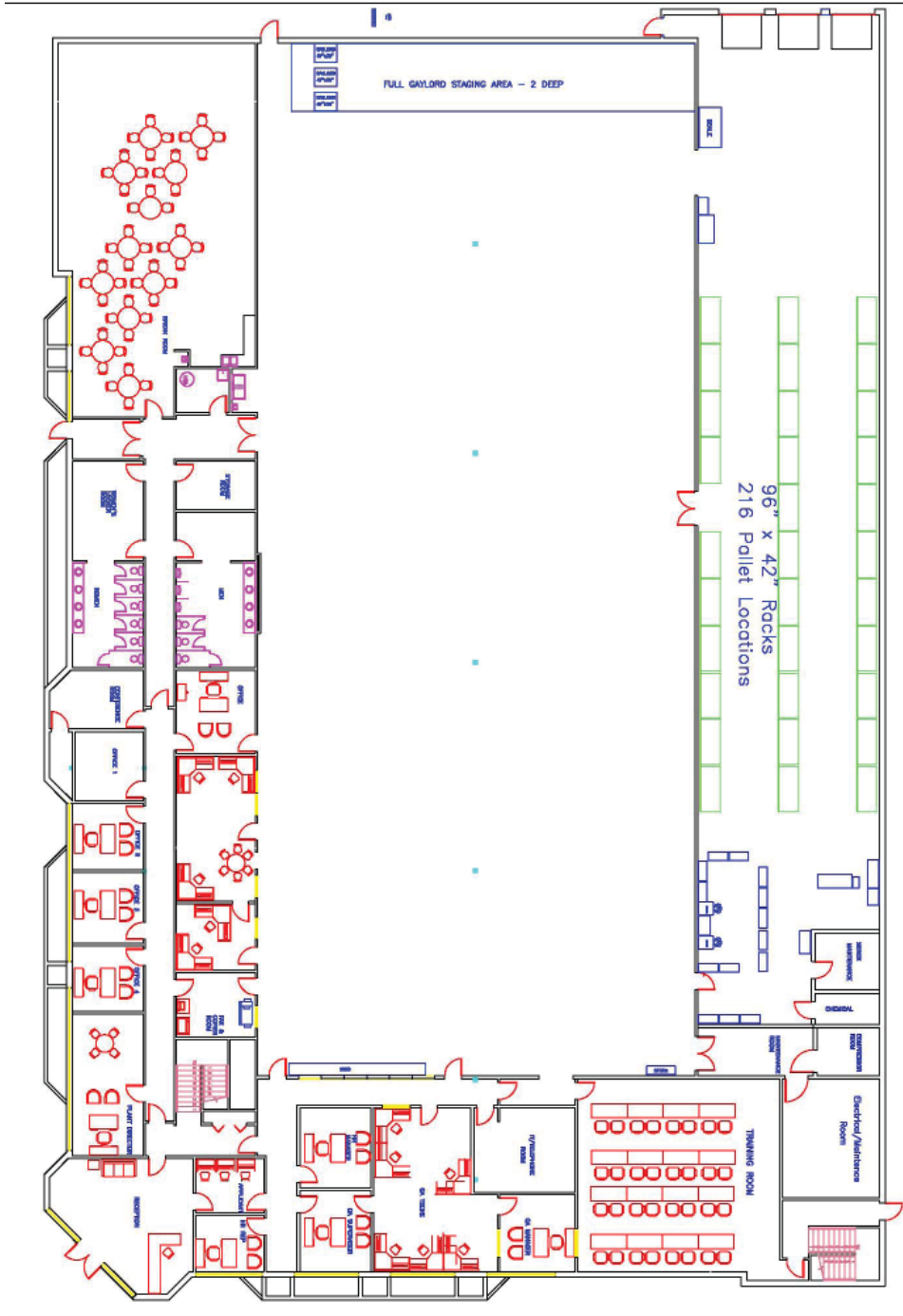

Contact Us

GREG COPPS SIOR

704 409 2361

CHARLOTTE, NC

greg.copps@colliers.com

COLLIERS INTERNATIONAL
212 S. Tryon Street, Suite 375
Charlotte, NC 28281

www.colliers.com

The information contained herein has either been given to us by the owner of the property or has been obtained from sources that we deem reliable. We have no reason to doubt its accuracy, but we do not guarantee it. This property is subject to prior sale, lease, price change or withdrawal without notice. Note: Broker participation is welcomed. Compensation is offered to buyer/tenant representative.

